

1. Remove existing valve components. Thoroughly clean and inspect interior of valve.
2. Drop in the supplied removable seat. The seat should have a gasket on the bottom side and a spring affixed to the top.
3. Thread in Tunstall insert assembly and secure.
4. Affix the operator to the top of the insert assembly.

Pictured to the left is a typical installation. Retrofit kit may or may not include spring and removable seat. Skip the steps that do not apply and proceed with your installation.

That's it!

Now your radiator is under "Macon Control."

If you have any questions do not hesitate to call your representative or the factory.

CONVERSION
INSERTS

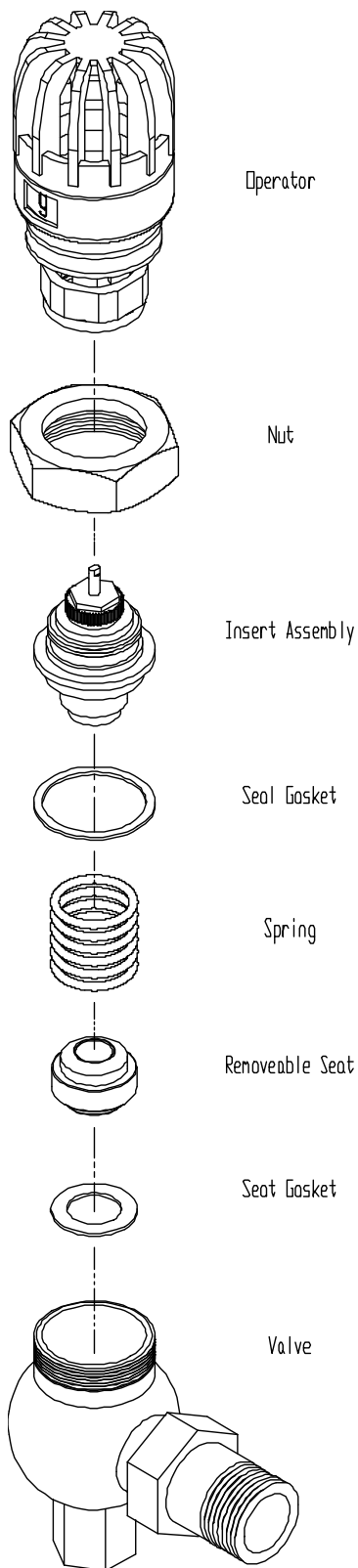

1. Remove existing valve components. Thoroughly clean and inspect valve seat.
2. Drop in the supplied removable seat. Be certain the seat gasket is on the bottom. Now place the spring on top of the seat and make sure that it reaches the valve shoulder.
3. Drop the insert assembly and seal gasket (if applicable). Secure the Tunstall E-Z Fit™ conversion kit with the nut supplied.
4. Affix the operator to the top of the insert assembly.

Pictured to the left is a typical installation. Kit may or may not include spring, removable seat, or upper insert seal gasket. Skip the steps that do not apply and proceed with your installation.

That's it!

Now your radiator is under "Macon Control."

If you have any questions do not hesitate to call your representative or the factory.

